

St. Jakob-Park Basel

Stadion

Konferenz	Bankett	Konzert	Fläche
			m ²

1 Umgang	Details auf Anfrage
2 Spielfeld	Details auf Anfrage
3 Tribünen	37 940 Gäste, Details auf Anfrage
4 Terrasse	Details auf Anfrage

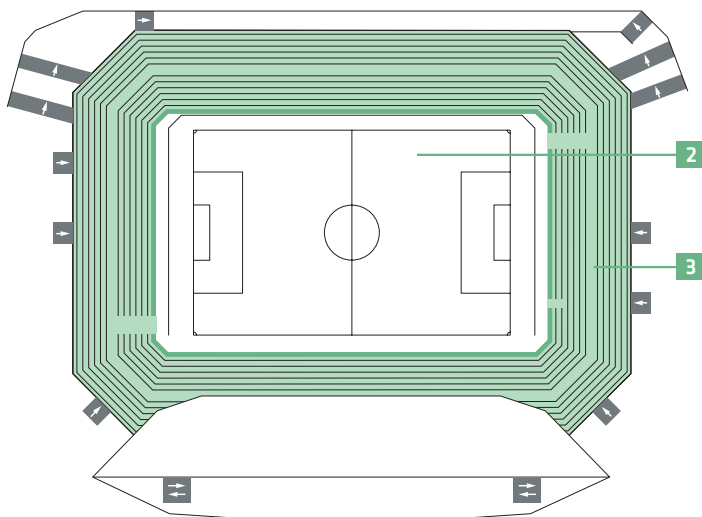
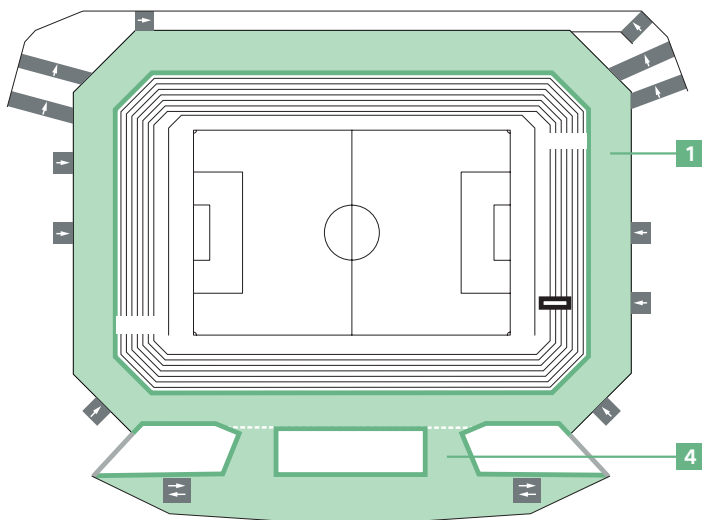

St. Jakob-Park Basel | 1. OG

Captains Lounge

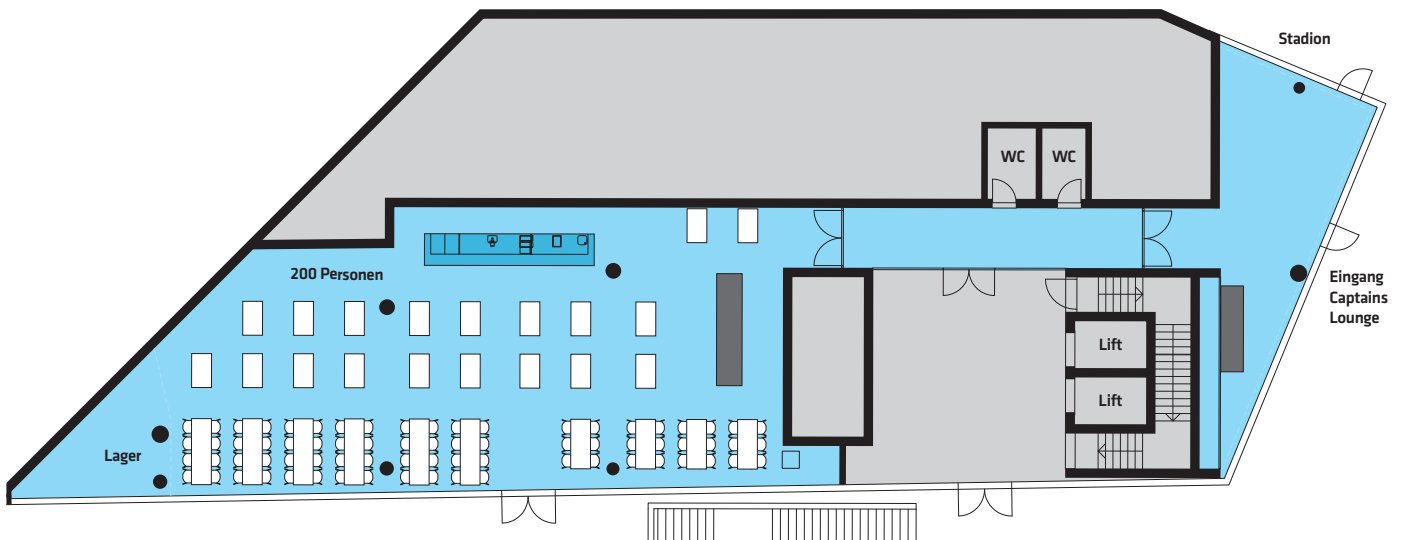
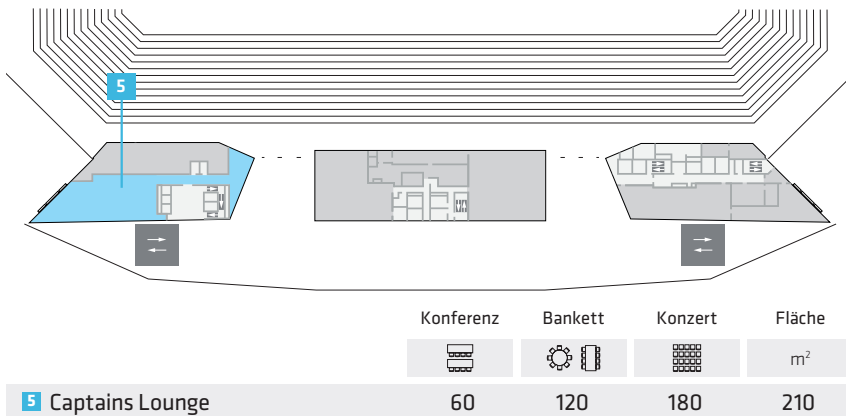

St. Jakob-Park Basel | 1. OG

V-ZUG Lounge

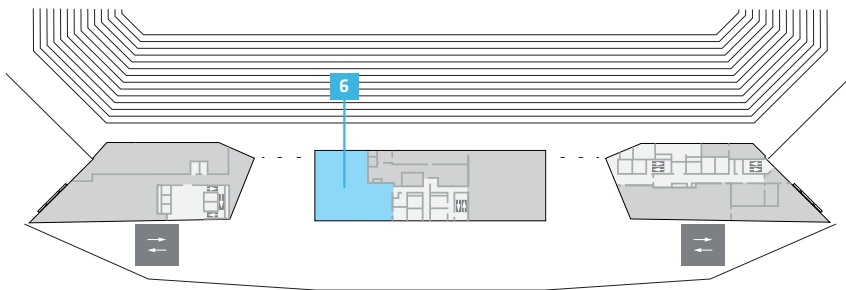

Konferenz Bankett Konzert Fläche



6 V-ZUG Lounge	Konferenz	Bankett	Konzert	Fläche
	a. A.	120	a. A.	210 m ²

a. A. = auf Anfrage

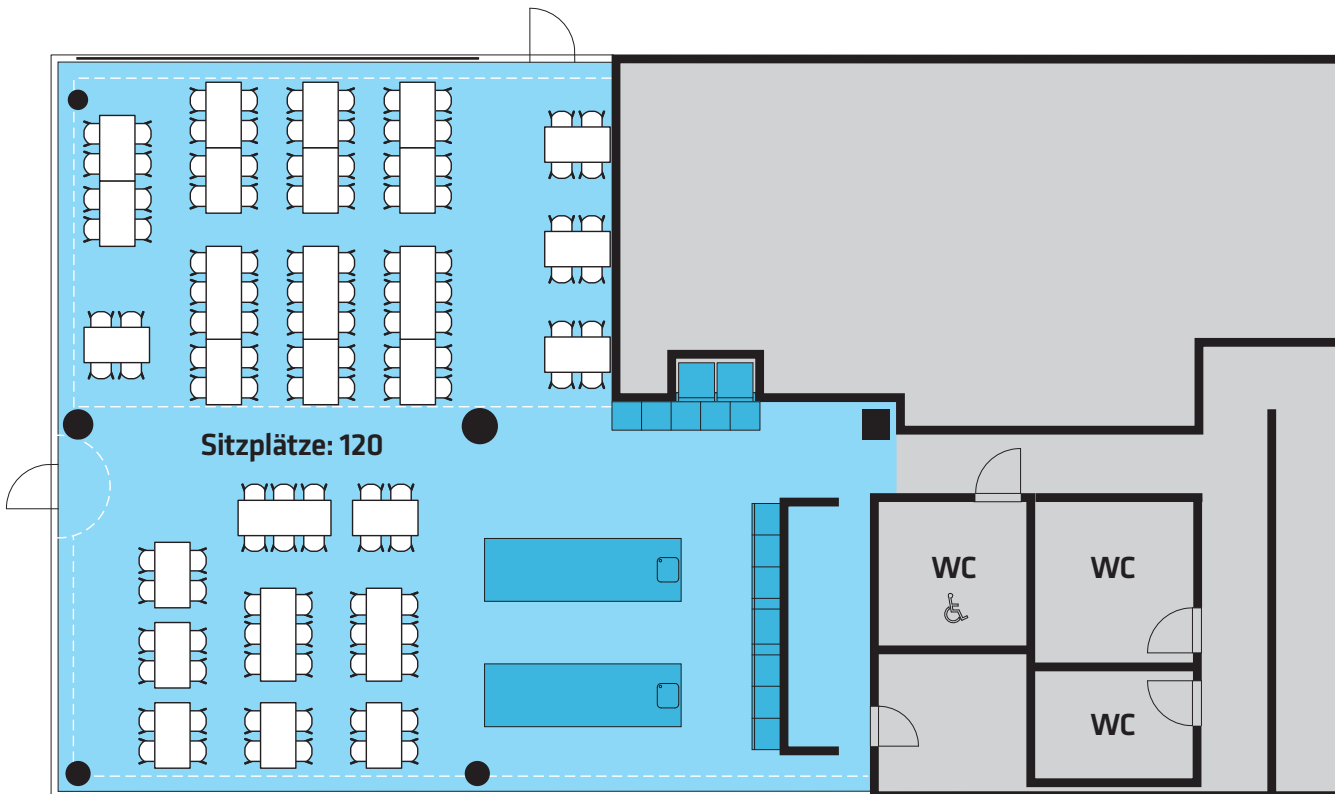

St. Jakob-Park Basel | 2. OG

Corner-Bar

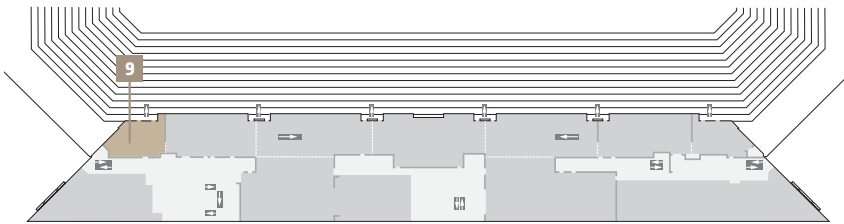

Konferenz Bankett Konzert Fläche



m²

9 Corner-Bar

20



50

40

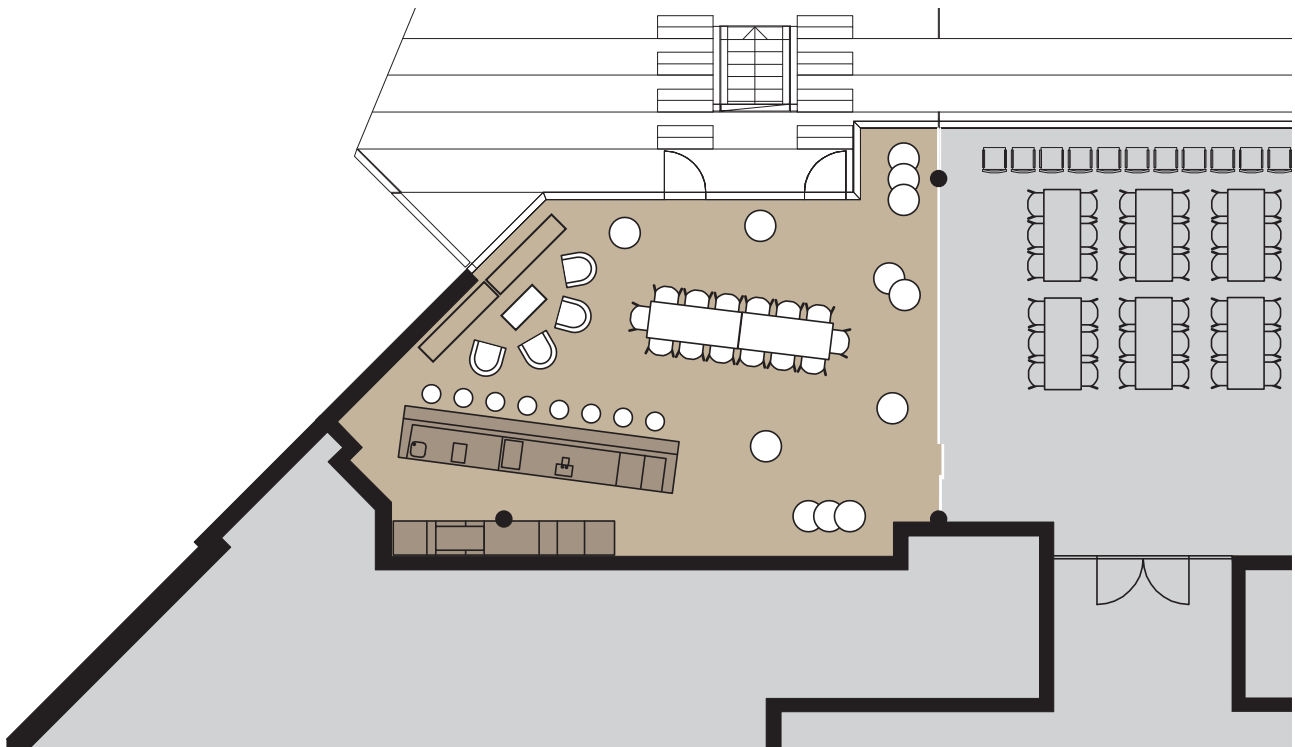
90



Baloise Lounge

Konferenz	Bankett	Konzert	Fläche
			m ²
a. A.	926	a. A.	1700

a. A. = auf Anfrage

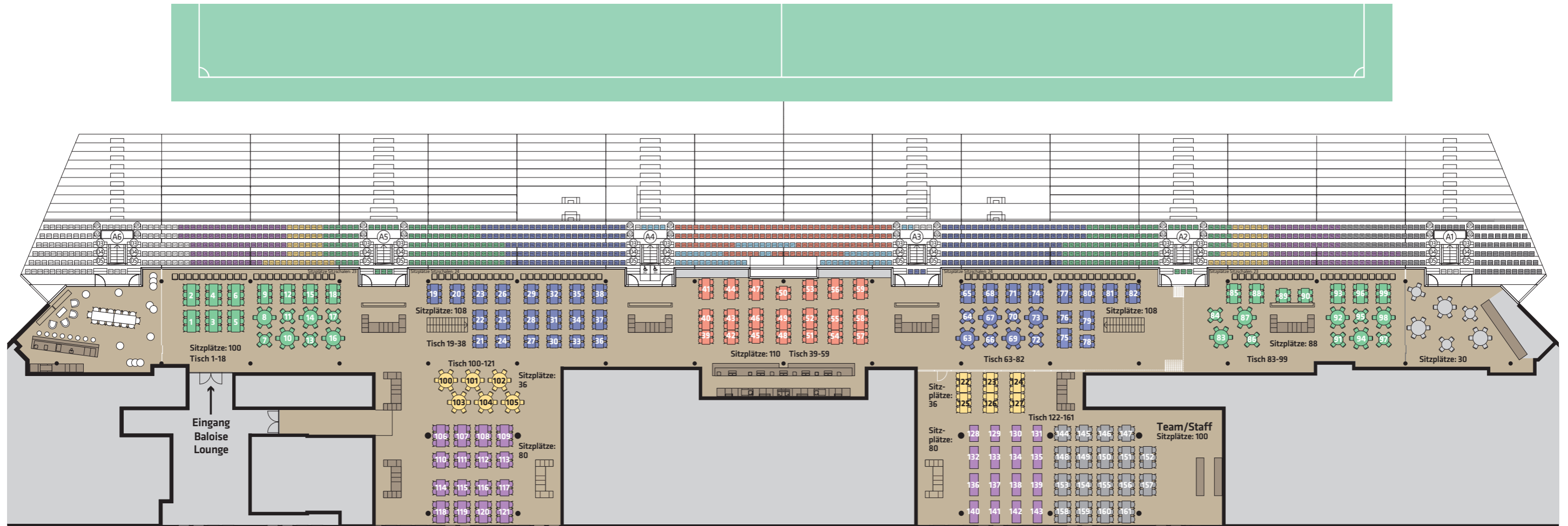

Premium Lounge

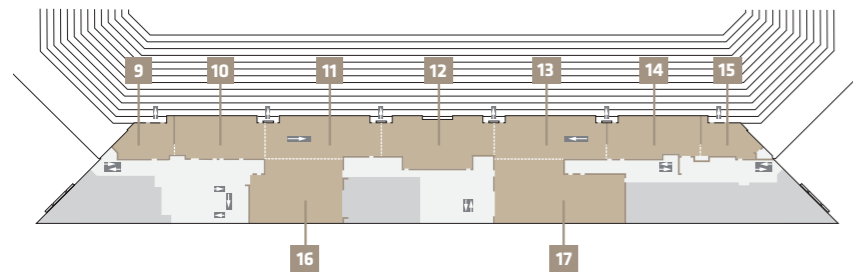

	Konferenz	Bankett	Konzert	Fläche
				m ²
9 Corner-Bar	20	50	40	90
10 Premium Lounge Eingang	a. A.	100	a. A.	157
11 Premium Lounge West	40	108	50	242
12 Premium Lounge Mitte	80	110	100	150
13 Premium Lounge Ost	40	108	50	242
14 Donatoren-Raum	60	88	140	178
15 FCB-Lounge	15	30	30	88
16 Konferenz 1	70	116	140	250
17 Konferenz 2	100	216	240	270
Premium Lounge Total	a. A.	926	a. A.	1700

a. A. = auf Anfrage

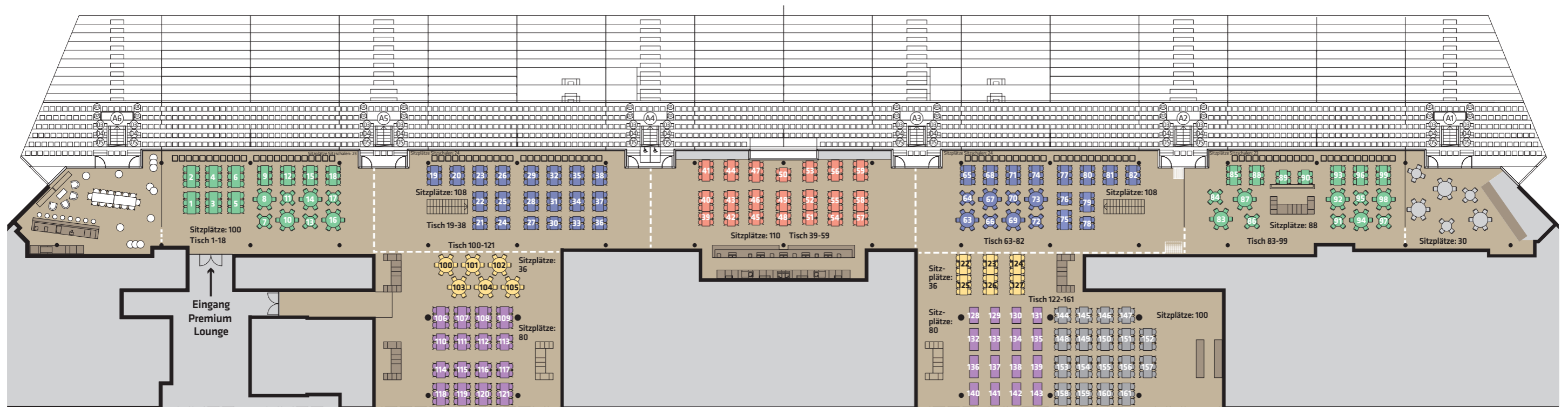

St. Jakob-Park Basel | 3. OG

Warteck Box Pub



Konferenz Bankett Konzert Fläche



m²

18 Warteck Box Pub

-

40

-

110

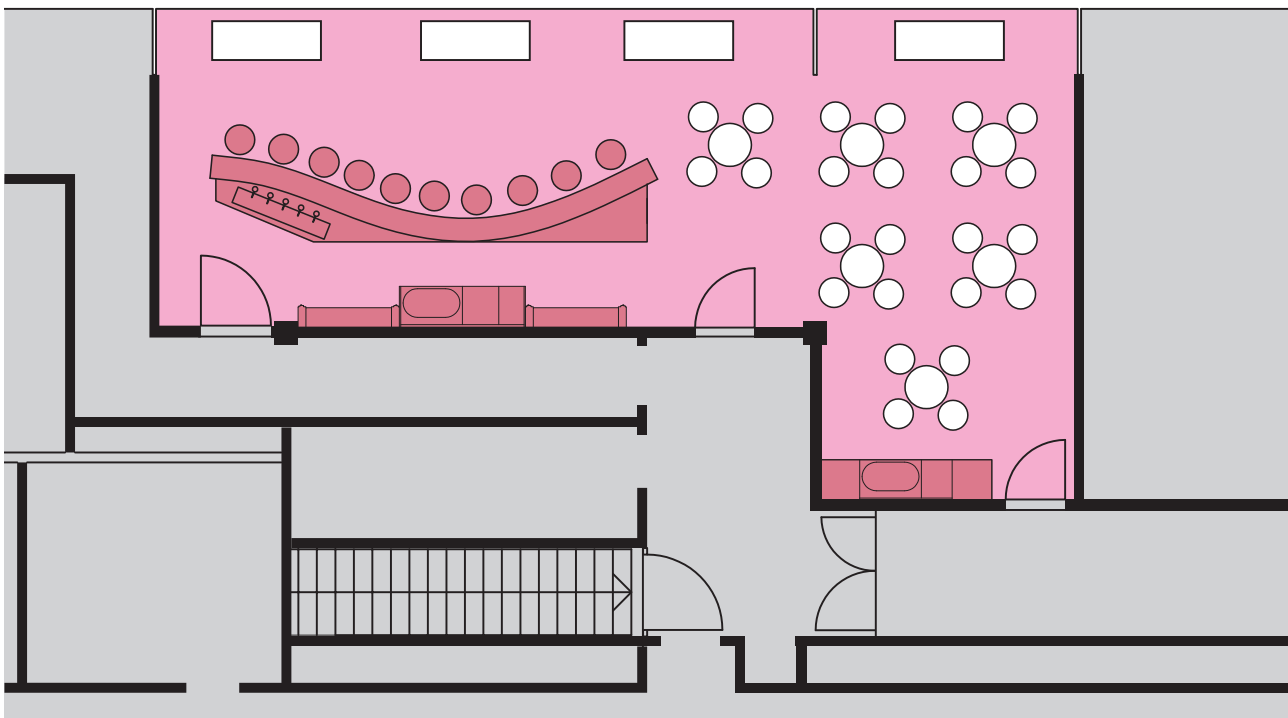

St. Jakob-Park Basel | 3. OG

Sky Lounge

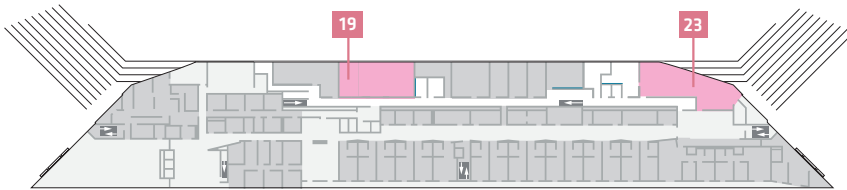

	Konferenz	Bankett	Konzert	Fläche
				m ²
19 Sky Lounge	10	a. A.	15	66
23 Dinner Room	a. A.	60	a. A.	140

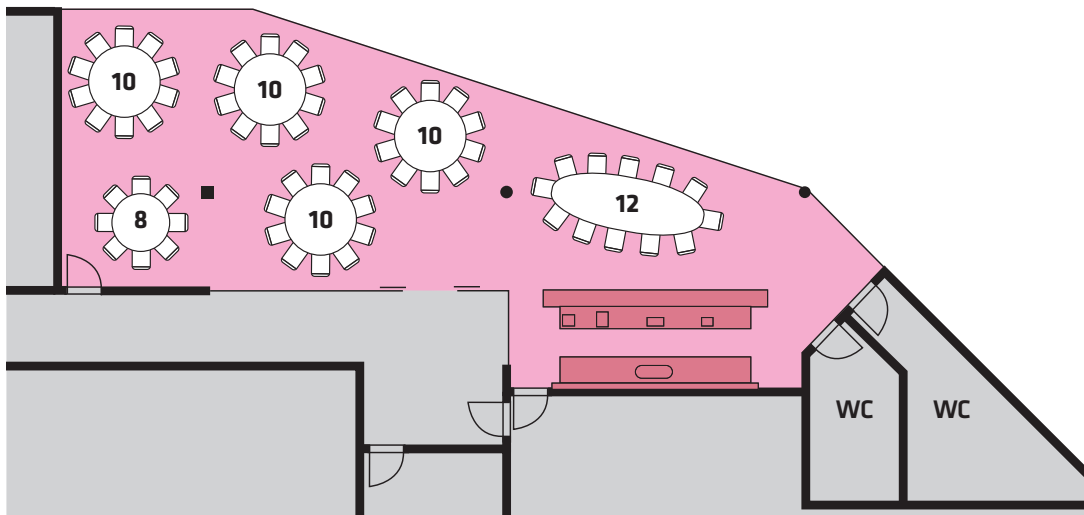
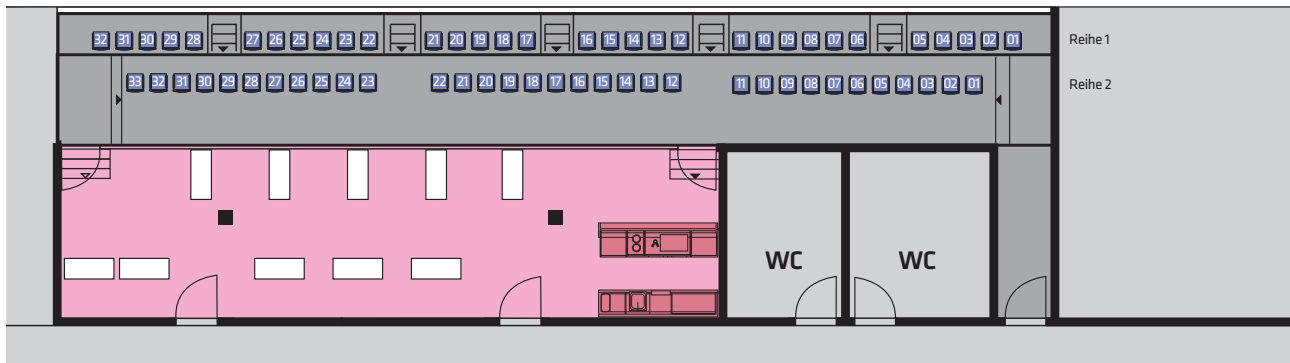

a. A. = auf Anfrage

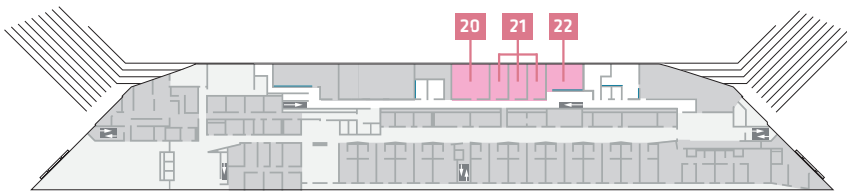

St. Jakob-Park Basel | 3. OG

Logen



	Konferenz	Bankett	Konzert	Fläche
				m ²
20 FCB-Stüübli	-	20	-	60
21 8er-Logen	-	8	-	30
22 16er-Loge	-	16	-	45

